

Gas/wood/multi-fuel fireplaces and stoves 2018
designed by DRU



Global
BY DRU

Dik Geurts



Contents

3



Gas,
built-in fires and stoves
GLOBAL RANGE

23



Wood and multi-fuel,
inserts, built-in fires and stoves,
DIK GEURTS

50



Wood and multi-fuel,
stoves,
DRU

*Subject to change. The colours in this brochure
may vary from the actual products. Nothing in this
publication may be used without prior written consent
from DRU Verwarming B.V.*

Gas,
built-in fires and stoves,
Global fires

Global
BY DRU



CONTENTS

- 04 Why choose Global fires?
- 06 Fire beds and interior finish
- 07 Open/closed combustion and Direct flue
- 08 Energy efficiency class and types of gas
- 09 Closed combustion fires
 - Global 55XT Cavity BF
 - Global 60XT BF
 - Global 70XT BF
 - Global 100 BF / 120 BF
 - Global 60 Corner BF
 - Global 100 Corner BF / 120 Corner BF
 - Global 60 Triple BF
 - Global 100 Triple BF / 120 Triple BF
- 17 Open combustion fires
 - Global 40 CF
 - Global 55 CF
 - Global 55XT CF
 - Global 70XT CF
 - Global Beau CF (freestanding fire)
- 22 Accessories

WHY CHOOSE GLOBAL FIRES?

Nothing matches up to the pleasure of lighting a good fire on a cold winter's day or a damp summer evening. Global gas fires have a modern design and a highly realistic and lively flame effect. The high flames give your house a warm atmosphere, whilst providing comfort, user friendliness and warmth.

The price of Global gas fires is attractive. It is an investment that gives back and will bring you an enormous amount of pleasure. Our range is highly varied, since all tastes need to be catered for. You can adapt your fire as you wish, thanks to our fireplaces and frames. All our fireplaces have a single thing in common: they are compact and therefore do not take up a lot of space. If you are looking for a gas fire, choose Global fires. Here is a short summary of the advantages: a varied range, compact models, high efficiencies and attractive prices. The choice is yours!



A VARIED RANGE - COMPACT MODELS - HIGH EFFICIENCY - ATTRACTIVE PRICES



INTELLIGENT SOLUTIONS

A varied range

Global fires are easy to install in your lounge, kitchen, bedroom or office. No major transformations are required for their installation. Some models can be directly connected to an existing chimney. We also have other closed combustion models, whose exhaust passes through an external wall or through the roof. It will be up to you to decide on the style or shape, we offer matching fireplaces or frames. When we say that our range is varied, it is not simply hot air!

Compact fires for extra space

The slim, well thought-out design forms the basis of each Global fire. Reducing the installation depth as much as possible constitutes a challenge in itself and ensures that your fire does not take over your room.

High efficiency

The efficiency of all our fires is very high. They provide excellent supplementary heating without costing the earth. Global fires therefore provide advantages in several respects for your home and your quality of life, and all this with high efficiency, low gas consumption and at very affordable prices too.

It's easy with gas

All our fires come with a remote control with electronic ignition. To turn on your fire, all you have to do is press a button. Gas heating is clean, easy and reliable. There will be no crackling of sparks, no dust or smoke. And a single press can turn off the system.

All Global fires are available in both natural gas and in propane.

Guarantee

A gas fire constitutes an investment. The aim is to take advantage of this for many years and it is therefore important to properly think before making your choice. A gas fire must be an asset for your home! Global fires meet the very highest quality standards. Each fire is subjected to a large number of in-depth checks before leaving the factory. We commit ourselves to offering you the best possible quality and the best possible services.



RANGE OF POSSIBILITIES

Choose the combination that suits you

When you choose a Global fire, you can decide on its composition. Would you like to have pebbles or would you rather have a set of logs? The pebbles give your fire a more trendy, modern look, whereas the sets of logs give your fire a warmer appearance.

Your interior finish can also be adapted to suit your wishes. The black or Ceraglass interior will give your fire a modern touch, whereas Ceraglass will give you a unique experience thanks to the reflection of the flames. Natural and classic brick finishes will produce a better effect in classic interiors. In combination with the appropriate fireplace or the ideal frame, you can achieve the perfect look, entirely tailored to your wishes.

INTERIOR FINISH

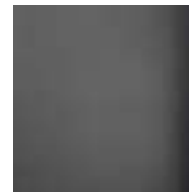

Black



Ceraglass
(flame reflecting)

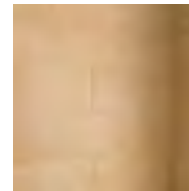

Natural

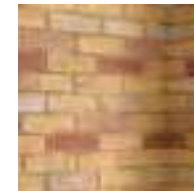

Classic stone

FIRE BED



Log set brown



Log set white

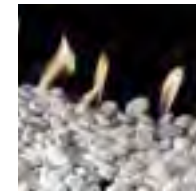

Stones white



Glass anthracite

CLOSED COMBUSTION FIRES **BF**

Closed combustion

Global fires are designed to be elegant, in keeping with the latest trends in interior decoration. You can combine them in an infinite number of ways thanks to their sophisticated design. A fire will add something to your interior, that extra special touch. Even if you do not have a chimney, you can achieve a magnificent set of flames. Allow yourself to be inspired by what you will find on the following pages!



Technical characteristics:

- The fire draws in the air required for combustion from outside via a concentric flue pipe and removes the combustion gases via the same pipe (balanced flue system).
- Thanks to PowerVent®, you can install your fire wherever you wish.
- This is the ideal solution for installation in a well-insulated home.
- Exhaust can take place via the external wall and the roof (a chimney isn't required).

DIRECT FLUE

For the majority installations of structures, a concentric flue pipe of one metre must first be installed at the level of the exhaust, before being able to form bend joints. In the case of certain structures with closed combustion, this is not necessary and exhaust can begin directly with an 90° bend.

This is in particular the case for the following models:

- | | | |
|-----------------------|------------------------|------------------------|
| • Global 60XT BF | • Global 100 BF | • Global 120 BF |
| • Global 60 Corner BF | • Global 100 Corner BF | • Global 120 Corner BF |
| • Global 60 Triple BF | • Global 100 Triple BF | • Global 120 Triple BF |

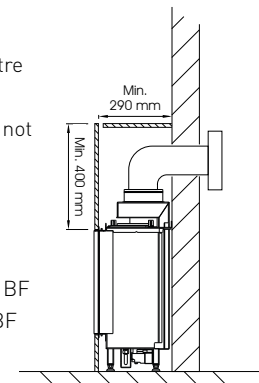

OPEN COMBUSTION FIRES **CF**

Open combustion

Your taste is what counts the most. The huge choice of interior finishings and the method of installation allow you to determine yourself whether you prefer a more modern look or a classic look. Would you like an elegant fireplace or a built-in fire, more sober in appearance? Everything is possible; we attach a great deal of importance to your wishes. The open combustion system can indeed be connected to an existing chimney. Allow yourself to be inspired by what you will find on the following pages!



Technical characteristics:

- Necessity of a chimney for the exhaust of combustion gases.
- The fire draws the air required for combustion from the room in which it is located.

ENERGY EFFICIENCY CLASS

Based on gas type G20

What does an energy label mean for you?

In addition to the energy label, we also use an energy sticker or energy efficiency class. The energy label tells you something about the energy consumption of the device to which the sticker is attached. It is important how efficiently the device consumes energy. After all, the more efficient the fire, the lower your energy consumption. The energy class is based on the product's efficiency; this is also the output listed in the brochure. The output expresses the difference between the energy consumed and the capacity delivered by the fire or stove.

TYPES OF GAS

Global by DRU fires are suitable for various types of gas.

Biogas, green gas and gas from overseas have become increasingly common. That is why Global by DRU has prepared its entire product range for the changing nature of gas. Each type of gas creates a different flame pattern. By taking this into account, we make sure that in the future you can continue to enjoy a lovely and attractive gas fire.

No connection to a gas network, but you would like to have an attractive gas fire?

Do you live in a remote area or is your residence heated only by district heating? Global by DRU has the solution. Nearly all our fires are suitable for propane gas, so in most cases it is still possible to install a Global by DRU gas fire.

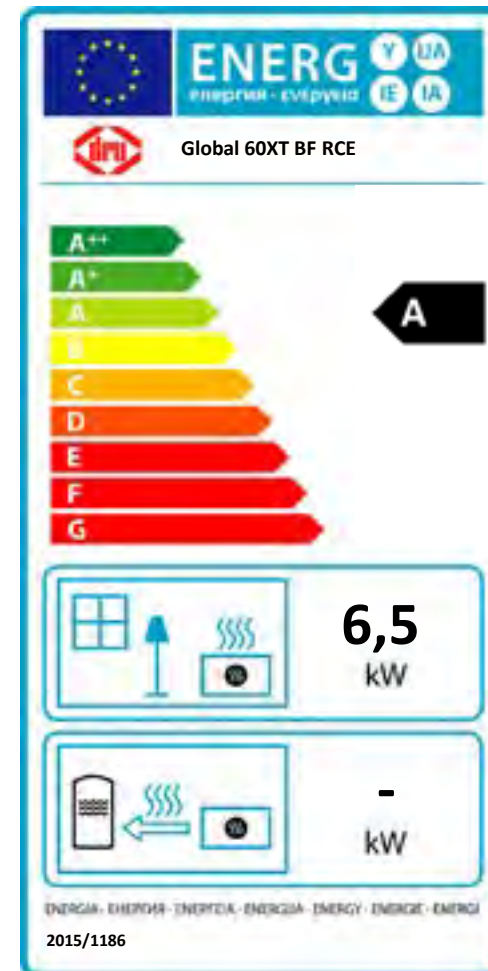



Built-in dimensions	
Width	667 mm
Height	855 mm
Depth	255 mm
Fuel bed	
Logs	+
Interior	
Ceraglass	+



Global
Truflame
Burner®



The perfect fireplace solution for homes with no chimney.

- Suitable for installation in a cavity
- Depth only 255 mm
- Eccentric concentric flue
- Including convection box to be used in cavity wall
- Option: Clear View (anti-reflective) glass

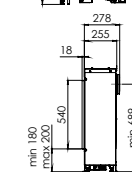
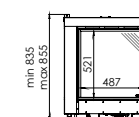
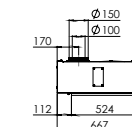

Global 55XT Cavity BF

Built-in dimensions	
Width	738 mm
Height	925 mm
Depth	295 mm
Fire bed	
Logs	+
Stones	+
Interior finish	
Black	+
Ceraglass	+

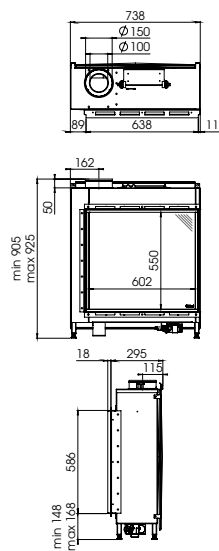

Global 60XT BF





Built-in dimensions	
Width	985 mm
Height	870 mm
Depth	362 mm
Fire bed	
Logs	+
Interior finish	
Black	+
Ceraglass	+
Natural	+
Classic stone	+

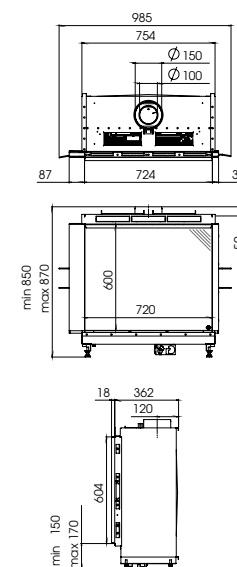

Global 70XT BF

Built-in dimensions 100/120	
Width	1154/1354 mm
Height	745 mm
Depth	360 mm
Fire bed	
Logs	+
Stones	+
Glass	+
Interior finish	
Black	+
Ceraglass	+

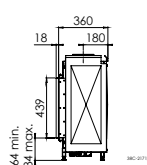
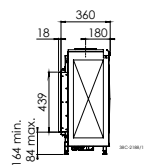
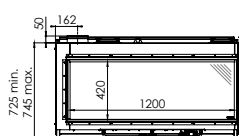
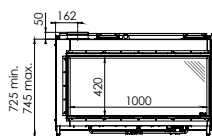
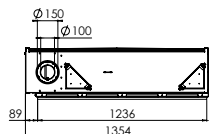
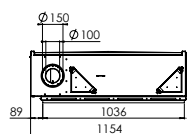

Global 100 BF

Global 120 BF

Global 120 BF



Built-in dimensions	
Width	810 mm
Height	825 mm
Depth	325 mm
Fire bed	
Logs	+
Stones	+
Interior finish	
Black	+
Ceraglass	+

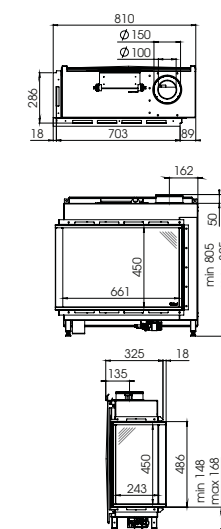

Global 60 Corner BF

Built-in dimensions		100/120
Width		1096/1296 mm
Height		766 mm
Depth		386 mm
Fire bed		
Logs		+
Stones		+
Glass		+
Interior finish		
Black		+
Ceraglass		+

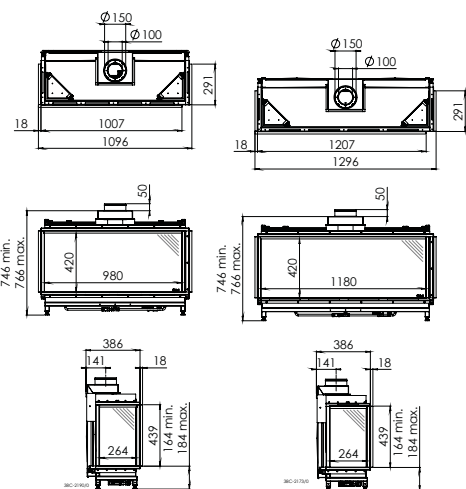

Global 100 Corner BF Global 120 Corner BF



Global 120 Corner BF



Built-in dimensions	
Width	746 mm
Height	816 mm
Depth	340 mm
Fire bed	
Logs	+
Pebbles	+
Interior finish	
Black	+
Ceraglass	+

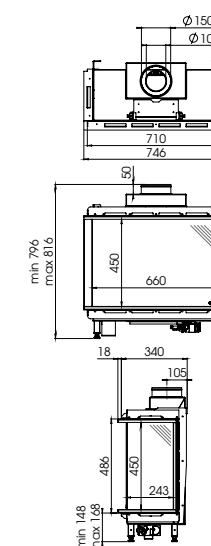

Global 60 Triple BF

Built-in dimensions 100/120	
Width	1096/1296 mm
Height	766 mm
Depth	386 mm
Fire bed	
Logs	+
Stones	+
Glass	+
Interior finish	
Black	+
Ceraglass	+

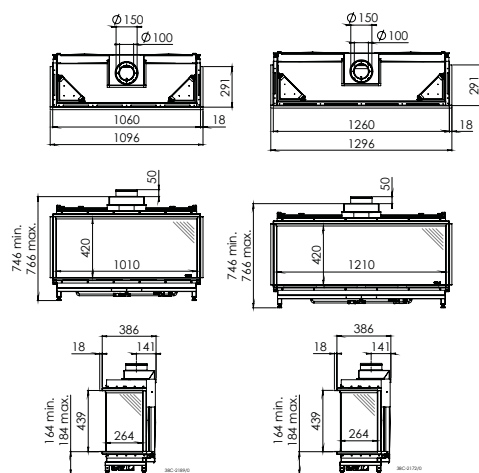

Global 100 Triple BF

Global 120 Triple BF



Global 100 Triple BF



Built-in dimensions	
Width	405 mm
Height	584 mm
Depth	291 mm
Fire bed	
Logs	+
Interior finish	
Ceraglass	+

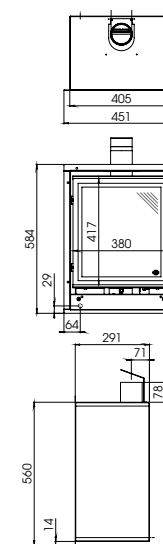

Global 40 CF

Built-in dimensions	
Width	549 mm
Height	539 mm
Depth	320 mm
Fire bed	
Logs	+
Interior finish	
Black	+
Ceraglass	+
Classic stone	+

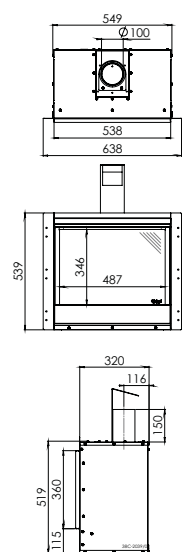

Global 55 CF





Built-in dimensions	
Width	549 mm
Height	714 mm
Depth	320 mm
Fire bed	
Logs	+
Interior finish	
Black	+
Ceraglass	+
Classic stone	+

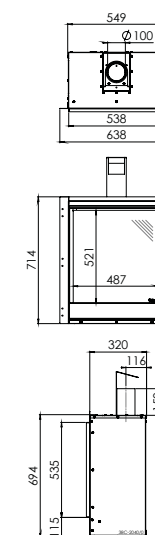

Global 55XT CF

Built-in dimensions	
Width	723 mm
Height	710 mm
Depth	350 mm
Fire bed	
Logs	+
Interior finish	
Black	+
Ceraglass	+
Natural	+
Classic stone	+

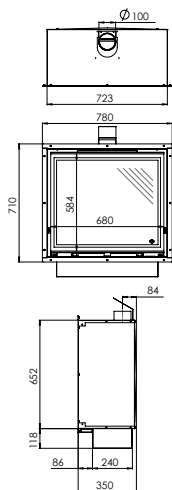

Global 70XT CF





Built-in dimensions	
Width	445 mm
Height	624 mm
Depth	330 mm
Fire bed	
Logs	+
Interior finish	
Ceraglass	+



Also available in enamelled ivory

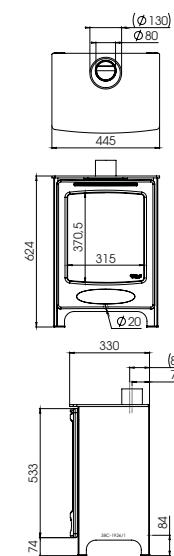

Global Beau CF

ACCESSORIES

Lux elements

Lux elements:

- Required for the ventilation of the chimney (structure protection).
- Generally to be fitted with designer lighting elements.

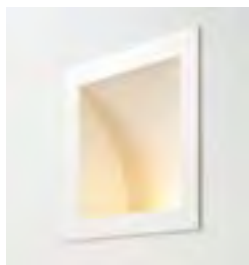

Lux ❶ ❷

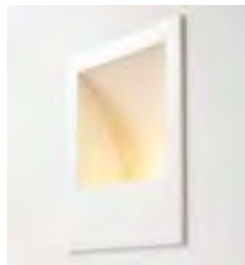

Lux Omni ❶ ❷



Lux Sleeve ❶ ❷



Lux Lignum ❶ ❷



Lux Fino ❶ ❸

❶ Ivory White ❷ Alu-metallic ❸ Anthracite

Control hatch

- For installation of the gas valve (BF fires)



Remote control

RCE: remote control with electronic ignition, thermostat and clock functions.



Wood,
inserts, built-in fires and stoves,
Dik Geurts



CONTENTS

- 24 Why choose Dik Geurts fires
- 25 Wood stove technology and the environment
- 26 Custom made solutions
- 27 **Instyle insert and built-in fires**
 - Instyle 500^{EA}, 550^{EA}, 600^{EA}, 650^{EA}, 700^{EA}, 800^{EA}, 1000^{EA}
 - Instyle Corner^{EA}
 - Instyle Triple^{EA}
 - Instyle Tunnel^{EA/RS}
- 33 **Prostyle/Vision insert and built-in fires (with screen-printed glass)**
 - Prostyle 500^{EA}, 550^{EA}, 600^{EA}, 650^{EA}, 700^{EA}, 800^{EA}, 1000^{EA}
 - Prostyle Tunnel^{EA}
 - Vision 80^{EA}, Vision 100^{EA}
- 38 **Instyle/Prostyle insert fires with ventilating fan**
 - Instyle/Prostyle 600V^{EA}, 700V^{EA}, 800V^{EA}, 1000V^{EA}
- 40 **Technology**
 - Connection options
 - Frames
 - Accessories
- 44 **Freestanding wood and multi-fuel stoves**
 - Aste 5 Low^{EA}
 - Ivar 5 Low^{EA}, Ivar 5 High^{EA}
 - Ivar 5 Store^{EA}
 - Ivar 8 Low^{EA}
 - Ivar 8 Store^{EA}
 - Keld 5 Low^{EA}, Keld 5 High^{EA}

WHY CHOOSE DIK GEURTS?

Design, warmth and craftsmanship

Dik Geurts has rightly earned a name for itself within the wood burning industry. Quality and ease of use are top of our brief, along with characteristic design. Our extensive product range means we have a suitable unit for practically any living space. High efficiency and low emissions help contribute to a better environment.

Showrooms and dealers

Dik Geurts has numerous points of sale throughout Europe. These dealers are regularly trained and can make you a complete offer, including expert installation. Let one of our Dik Geurts dealers advise you on the most suitable unit for your living space and requirements.

Dik Geurts holds Uganda in high esteem

By purchasing a Dik Geurts product you are providing a better future for Ugandan women. Via the 'Stove for you; future for her' project a percentage of the profits are used to provide women in Uganda with microcredits, in order to start their own business.

A size to fit all

It is important that you purchase a fire or stove that is in proportion to the size of your living space. A fire or stove that's too small won't provide sufficient warmth, and a model that's too large will do the opposite. Putting less wood in it isn't really an option as the fire won't burn adequately, resulting in lower efficiencies and higher emissions. Be aware therefore that you purchase a fire or stove that provides you with good output and low emissions. In this respect the Dik Geurts fires and stoves provide the very best.



Insert fires, built-in fires and stoves

An insert fire can be placed in an existing open fireplace. An open fireplace provides little warmth and as a result uses a lot of wood, which is why many people place an insert fire instead. A built-in fire can be placed in a new situation. The fire is first positioned and connected, after which the casing is placed around it. A stove that is free standing doesn't need to be built-in. All Dik Geurts fires and stoves provide high efficiency. The numerous sizes and capacities make choosing the right model easy for you.



Situation before



Situation after



Energy label

- All Dik Geurts wood stoves are supplied with an energy label.
- The label contains an energy efficiency class.
- This energy class helps you to choose the perfect wood stove.

Approvals

The Dik Geurts models meet the most stringent quality requirements and belong in the combustion technique elite. The benefits for you: high efficiency, low emissions and glowing flames encased in a superb modern design.

Defra approved

Almost all Dik Geurts fires are Defra approved for the UK smoke controlled areas.



WOOD STOVE TECHNIQUES

Wood stove techniques

A Dik Geurts wood appliance isn't merely a receptacle in which to burn wood. Rather, it's a well thought-out piece of equipment that ensures the wood is burned as efficiently and cleanly as possible. So how do we achieve that?

Firstly, the models have a closed burning base (i.e. no grate), which catches the ash. The flat base covered in ash provides excellent insulation. You only remove the ash once it threatens to overspill the ash sill. Secondly, the combustion chamber in all our models is optimally insulated with vermiculite and the flue gases are fed off via an ingenious labyrinth.

Operation

All the Dik Geurts models are easy to use with a single control handle that regulates combustion air. Once you have stoked sufficiently, close off the combustion air flow and the model supplies sufficient air by itself to optimally complete the combustion process. This excellent air supply means the models light very easily too.

Dik Geurts "Master of Convection"

Nearly all Dik Geurts stoves and fires are so-called "convection stoves", i.e., aside from radiant heat they also provide heat circulation in a living space, resulting in optimum heat distribution. As such all Dik Geurts insert and built-in fires come equipped with a 2nd heating mantel, the so called 'convection mantel'. Nearly all the free-standing stoves come equipped with double heating mantel parts. These heat up the cold air very quickly, that then spreads throughout the living space far more evenly.

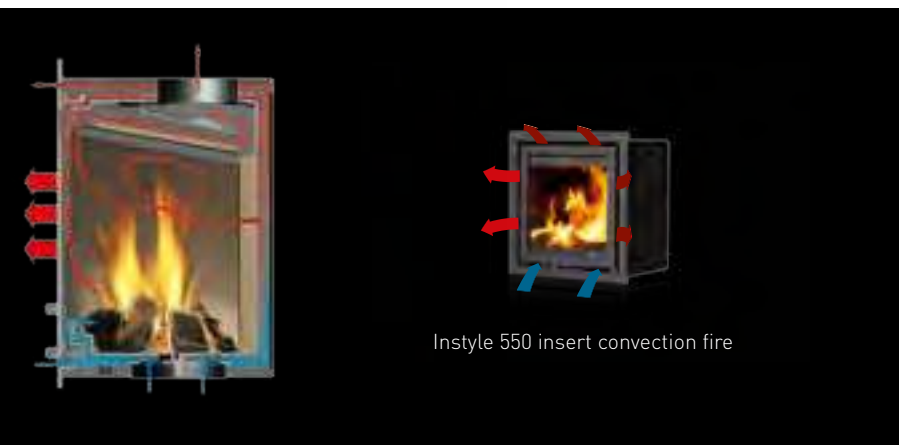

ENVIRONMENT



Carbon neutral

When you burn wood you are in principle being carbon neutral. As a tree grows it takes CO₂ from the atmosphere. When the tree is cut down and burnt this CO₂ is released. As intake and emission balance each other out, carbon neutrality occurs. It makes no difference whether the tree is rotting on the ground or is being burnt. In both cases the CO₂ that's been stored is released. It is vital that sustainably sourced wood is used, i.e., that for each tree cut down a new one is planted. This maintains the equilibrium.

Environment

Burning wood can be damaging to the environment if certain conditions aren't respected. Firstly, a decent fire or stove is required; one that ensures the combustion temperature is as high as possible, resulting in optimum clean burning. Secondly, it's vital that adequate, dry wood is used. It doesn't in actual fact make any difference which tree the wood derives from, as long as it isn't polluted (e.g. with paint residue) and as long as it is well and truly dry. Wet wood results in too low a combustion temperature and a large amount of unnecessary smoke and soot.



CUSTOM MADE SOLUTIONS AND OPERATING PROCEDURE



Your choice (rectangular flue)

+



Custom made solution

=



Exclusive fire

Custom made solutions

The Dik Geurts products options are extensive. Yet it may be that nothing fits. You are looking for an insert fire in an existing fireplace or open fire but none of the standard models are suitable in terms of dimension. The opening is too high, deep or indeed too shallow. There is a solution! We can make a custom made insert fire for you at a small additional charge. Sometimes all that's needed is a small modification to the front frame.

Operating procedure

Your Dik Geurts dealer will take all the necessary measurements and will complete the special custom made form. We will then draw the fire for the dealer as per the requested dimensions. Once this has been verified we commence production of your custom made fire. Delivery time is on average is 4-6 weeks. The custom-made fires are available in front, corner, triple and tunnel models.

Custom-made insert fires

Instyle Front (500^{EA}-1000^{EA} range), Corner^{EA}, Triple^{EA}, Tunnel^{EA/RS}

- Max. 10% deviation

Custom-made frames

Instyle/Prostyle Front (500^{EA}-1000^{EA} range), Tunnel^{EA/RS}

- Solid frames (Classic Line)
- Width 12-100 mm



Instyle 550^{EA}/built-in frame

Instyle range



Prostyle
screen-printed
glass

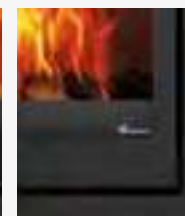

Instyle glass

Instyle insert and built-in fires

Instyle 500^{EA}



Instyle 550^{EA}



Instyle 600^{EA}



Instyle 650^{EA}



- Insert/built-in fire with ventilated glass
- With external air connection rear or base Ø 80 mm (accessory)
- Upper chimney connection
- Upper convection connection

- Available with detachable frames (see pg. 42)
- Custom made possible (see pg. 26)
- Connection options and accessories (see pg. 40)

Instyle + Classic Line frame

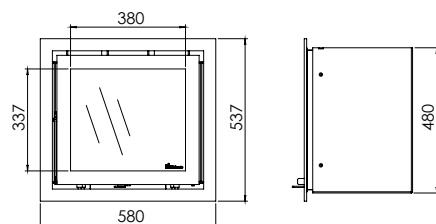
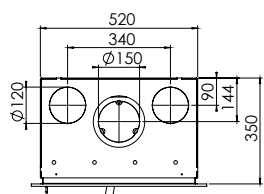

Instyle 500^{EA}

Output 3-7 kW
Efficiency 82.0%

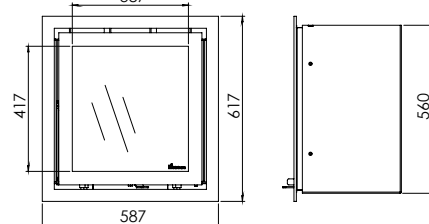
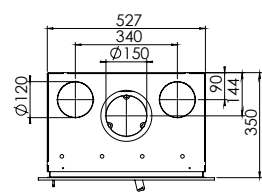

Instyle 550^{EA}

Output 3-7 kW
Efficiency 81.0%

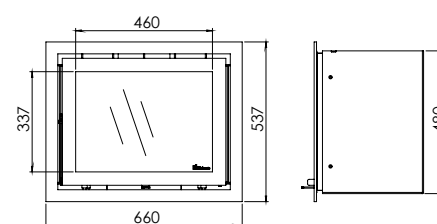
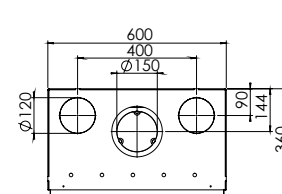

Instyle 600^{EA}

Output 3-7 kW
Efficiency 80.0%

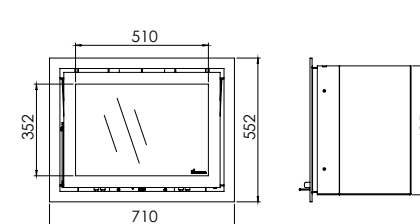
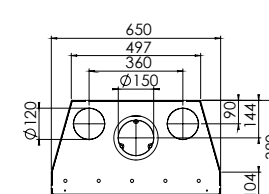

Instyle 650^{EA}

Output 5-9 kW
Efficiency 80.5%



EA: External air connection

Instyle 700^{EA}

Instyle 800^{EA}

Instyle 1000^{EA}



- Insert/built-in fire with ventilated glass
- With external air connection rear or base Ø 80 mm (accessory)
- Upper chimney connection
- Upper convection connection

- Available with detachable frames (see pg. 42)
- Custom made possible (see pg. 26)
- Connection options and accessories (see pg. 40)

Instyle + Classic Line frame

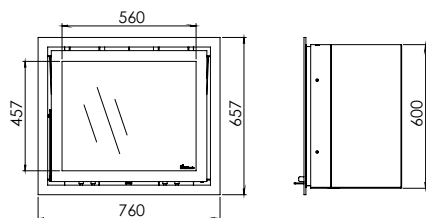
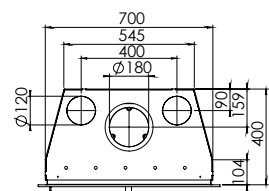

Instyle 700^{EA}

Output 8-12 kW
Efficiency 81.9%

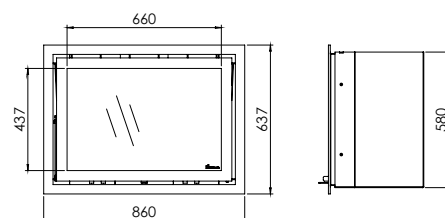
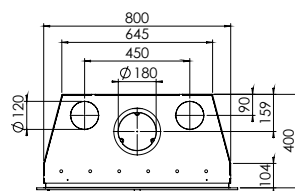

Instyle 800^{EA}

Output 8-12 kW
Efficiency 76.6%

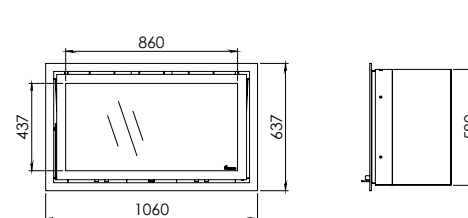
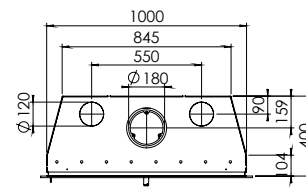

Instyle 1000^{EA}

Output 9-13 kW
Efficiency 77.7%



Instyle Corner Low ^{EA}	
Output	4-9 kW
Efficiency	83.0%
Instyle Corner High ^{EA}	
Output	4-9 kW
Efficiency	83.0%

The Corner fires come equipped with a side glass pane that can be positioned on the left or right, upon request. The Corner Low^{EA} is only 49.5 cm high, making it very suitable for built-in fires in an existing open fire. The steel edging is minimalist by design, making the glass surface extra large.

- Insert fire with fixed frame (width 20 mm)
- Upper chimney connection
- Very stable door with two closure points
- Custom made possibilities (see pg. 26)
- With external air connection
- Accessories: liner kit Pro, connector for flue pipe with reduced end (see pg. 40)

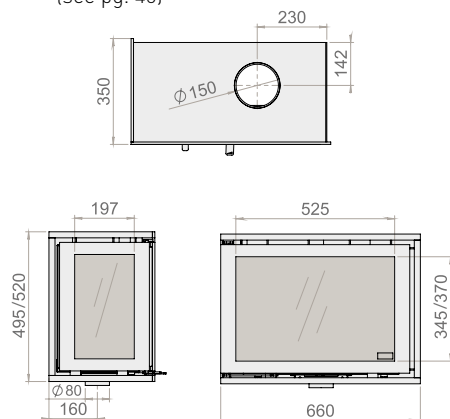

EA: External air connection



Instyle Triple Low ^{EA}	
Output	4-9 kW
Efficiency	83.0%

The Triple fire has glass on three sides. To provide optimum output the Triple Low^{EA} comes equipped with heat reflective infra-red side panes, resulting in extremely clean glass panes when burning. The Triple Low^{EA} is only 49.5 cm high making it very suitable for built-in fires in an existing open fire.

- Insert fire with fixed frame (width 20 mm)
- Upper chimney connection
- Large stable door with two closure points
- Custom made possibilities (see pg. 26)
- With external air connection
- Accessories: liner kit Pro, connector for flue pipe with reduced end (see pg. 40)

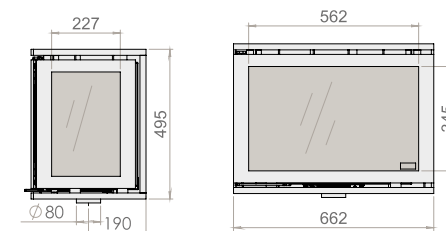
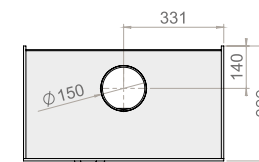

EA: External air connection

Instyle Tunnel ^{EA/RS}	
Output	9-12 kW
Efficiency	83.0%

The see-through Instyle Tunnel^{EA/RS} has glass doors on two sides. This means the stove can be positioned between two spaces, making the fire visible from both sides.

- Insert/built-in fire with two detachable (same or different) frames (see pg. 42)
- Upper chimney connection
- Custom made possibilities (see pg. 26)
- Version EA/external air of RS/room sealed (see pg. 40)
- Accessories: conversion kit (fresh outdoor air supply), liner kit Pro, external air connection (EA version), connector for flue pipe with reduced end, convection kit (see pg. 40)

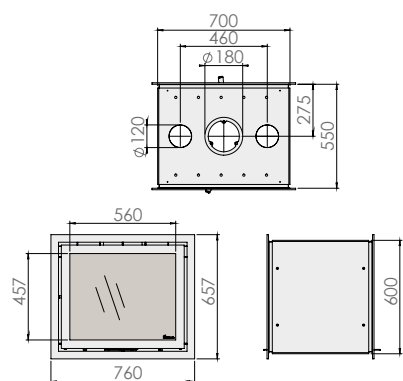

Instyle Tunnel^{EA/RS}/Classic Line frame



EA: External air connection / RS: External air connection, room sealed (100% airtight)



Prostyle 1000^{EA}/Modern Line frame

Prostyle range



Prostyle
screen-printed
glass

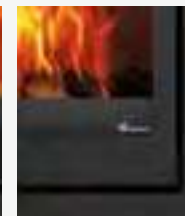

Instyle glass

Prostyle insert and built-in fires

Prostyle 500^{EA}



Prostyle 550^{EA}



Prostyle 600^{EA}



Prostyle 650^{EA}



- Insert/built-in fire with screen-printed ventilated glass
- With external air connection rear or base Ø 80 mm (accessory)
- Upper chimney connection

- Upper convection connection
- Available with detachable frames (see pg. 42)
- Connection options and accessories (see pg. 40)

Prostyle + Modern Line frame

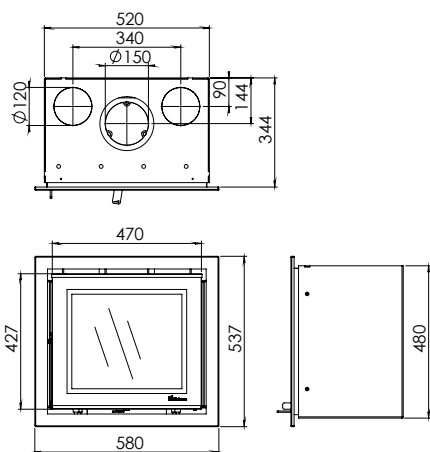

Prostyle 500^{EA}

Output 3-7 kW
Efficiency 82.0%

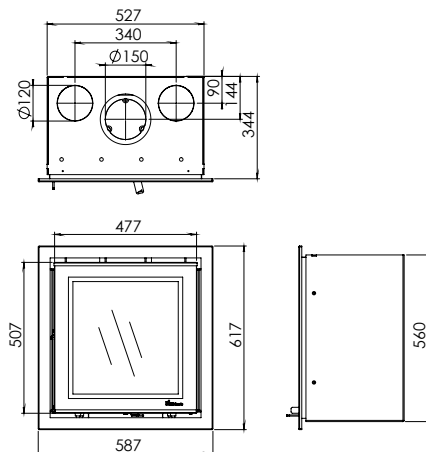

Prostyle 550^{EA}

Output 3-7 kW
Efficiency 81.0%

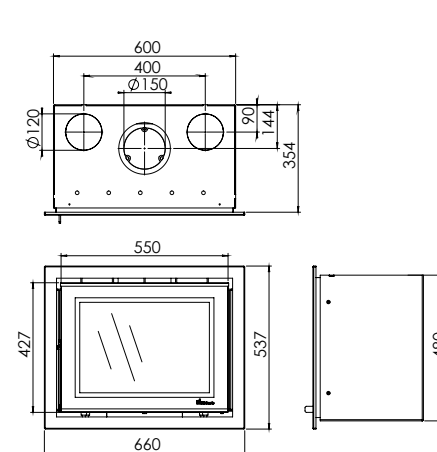

Prostyle 600^{EA}

Output 3-7 kW
Efficiency 80.0%

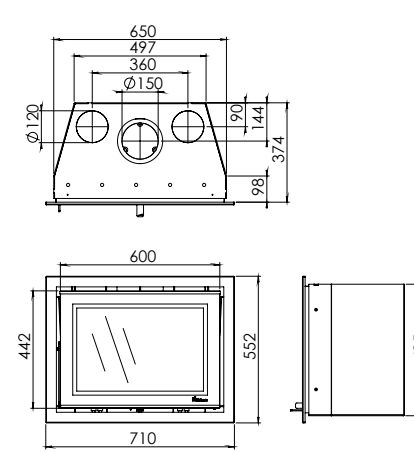

Prostyle 650^{EA}

Output 3-9 kW
Efficiency 80.5%



EA: External air connection

Prostyle 700^{EA}



Prostyle 800^{EA}



Prostyle 1000^{EA}



- Insert/built-in fire with screen-printed ventilated glass
- With external air connection rear or base Ø 80 mm (accessory)
- Upper chimney connection

- Upper convection connection
- Available with detachable frames (see pg. 42)
- Connection options and accessories (see pg. 40)

Prostyle + Modern Line frame

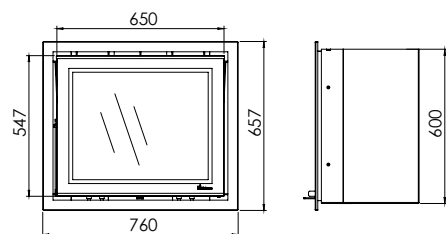
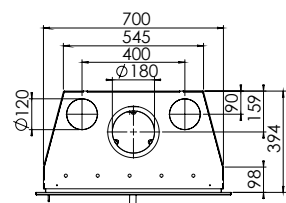

Prostyle 700^{EA}

Output 8-12 kW
Efficiency 81.9%

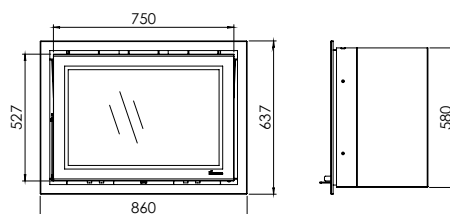
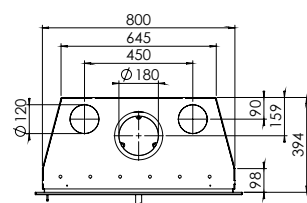

Prostyle 800^{EA}

Output 8-12 kW
Efficiency 76.6%

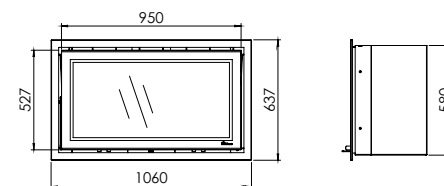
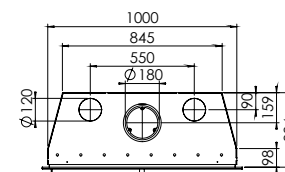

Prostyle 1000^{EA}

Output 9-13 kW
Efficiency 77.7%



Prostyle insert and built-in fires

Prostyle Tunnel ^{EA}	
Output	9-12 kW
Efficiency	83,0%

This 'room divider' is ideal for placement between two spaces, for example the living room and kitchen. The Prostyle Tunnel^{EA} has printed glass on two sides. There is a choice between several matching frames.

- Insert/built-in fire with two detachable (same or different) frames (see pg. 42)
- Upper chimney connection
- Custom made possibilities (see pg. 26)
- Accessories: external air connection, liner kit Pro, connector for flue pipe with reduced end, convection kit (see pg. 40)

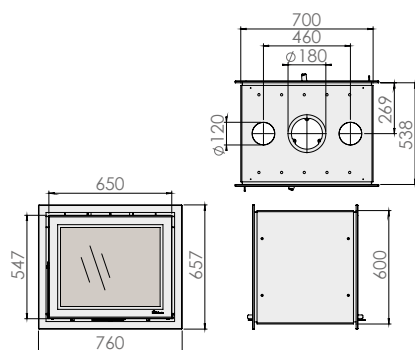

Prostyle Tunnel^{EA}/Modern Line frame

EA: External air connection





Vision 100^{EA}

Vision 80 ^{EA}	
Output	6-9 kW
Efficiency	84.6%
Vision 100 ^{EA}	
Output	7-10 kW
Efficiency	84.6%

- Built-in fire with built-in frame (built-in dept just 33 cm)
- Upper chimney and convection connection
- With external air connection
- User-friendly door mechanism
- With screen-printed glass
- Can be recessed
- Accessories: liner kit, ventilation elements Lux Basic and Lux Lignum

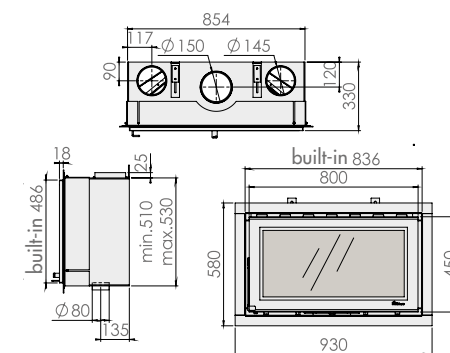

Vision 80^{EA}

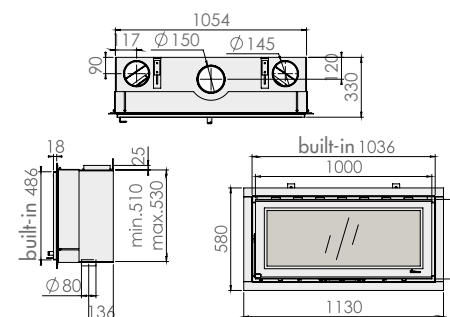

Vision 100^{EA}

EA: External air connection

Fires with fans

These fires are fitted with fans, allowing the room to be heated more quickly. Once switched on, they provide a warm flow of air from the front of the fire or via the convection openings.

Equipped with built-in fans (600V^{EA}/700V^{EA}/800V^{EA} 2x, can be switched off, 1000V^{EA} 4x, continuous)

- Control manual (on/off) or automatic (temperature switch)
- Four speed settings
- Safe 12V connection via an adapter
- Easy to access for maintenance and cleaning
- Air flow of 158 M3/h per fan (also via the convection openings)
- Connection options and accessories (see pg. 40)



Instyle 700V^{EA} / Classic Line frame

Instyle / Prostyle 600V^{EA}



Instyle 600V^{EA}

Instyle / Prostyle 700V^{EA}



Instyle 700V^{EA}

Instyle / Prostyle 800V^{EA}



Instyle 800V^{EA}

Instyle / Prostyle 1000V^{EA}



Instyle 1000V^{EA}

- Insert fire with standard ventilated glass
- With external air connection rear or base Ø 80 mm (accessory)
- Upper chimney connection

- Upper convection connection
- Available with detachable frames (see pg. 42)
- Connection options and accessories (see pg. 40)

Instyle + Classic Line frame and Prostyle + Modern Line frame

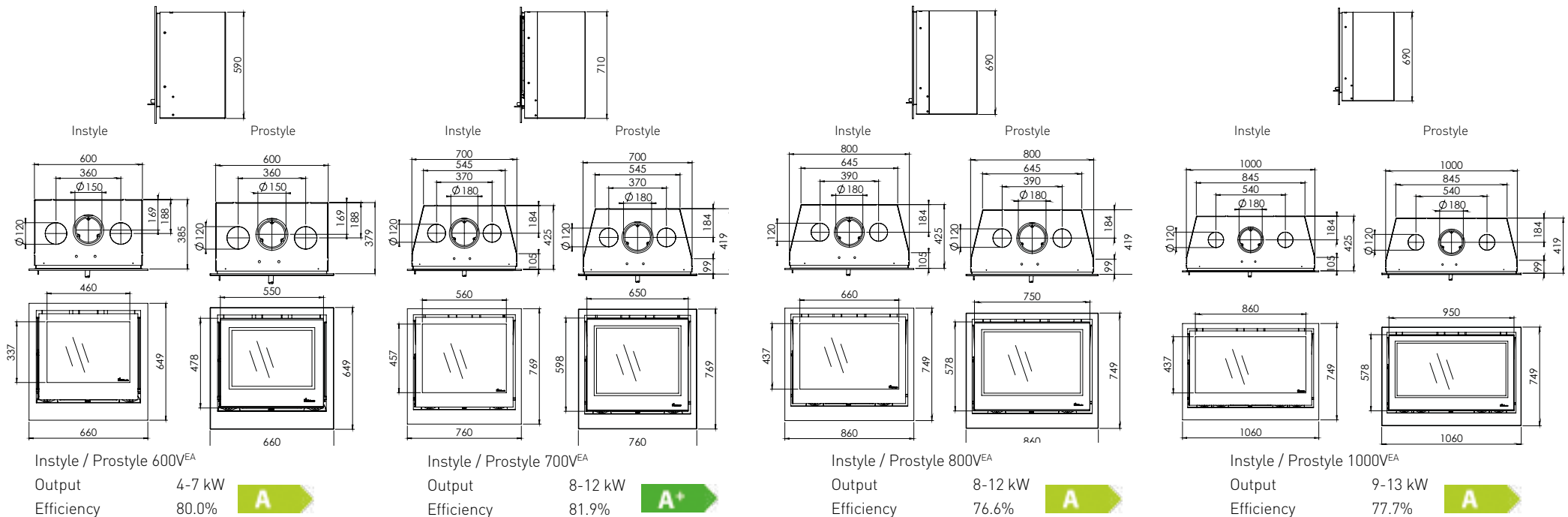

Instyle / Prostyle insert fires with ventilating fans

The Instyle and Prostyle insert and built-in-fires by Dik Geurts stand apart in their functionality and ease of installation. A great deal of attention has been paid to quality, clean combustion and high efficiency. The models are also equipped with the latest technology, such as an external air connection.

Air regulation



Simple air regulation

Convection connection



Ejectable convection openings



Convection set (2 convection rings)

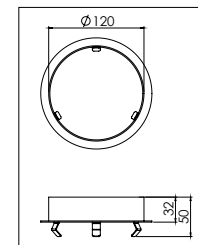

Improved regulation, cleaner emissions, improved glass pane ventilation

Door closure



- Stable and supple door closure
- Excellent cord seal
- The door is adjustable and exchangeable

Kit for selfclosing door (Instyle/Prostyle 500^{EA}-1000^{EA} series, Tunnel^{EA})



External air connection EA or RS

Houses are currently being insulated in a continuously better manner. In order to ensure that enough fresh air comes into the home, a ventilation system is installed. These systems are available as overpressure, neutral or under-pressure systems, and determine the choice of EA or RS.

Dik Geurts has designed two kinds of wood stoves with external air connection:

- EA ('External Air'), used in neutral or overpressure situations. Oxygen for the combustion comes mostly from outside.
- RS ('Room Sealed'), used with under-pressure in the living area so that no CO can be drawn in from the stove into the room. Oxygen for the combustion comes entirely from outside (wood stove is pressurised to 100% airtightness).

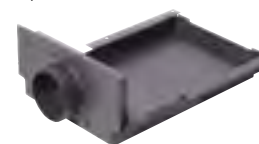

Rear connection

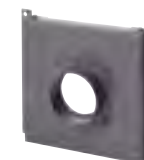

Base connection



Simple installation



Simple installation with the sloped sides on models Instyle / Prostyle 650^{EA} and 700^{EA}



Meets stringent testing requirements (CE, 1.BimSchV Stufe 2, Flamme Verte and DEFRA)

The various connection options of the Instyle and Prostyle fires mean you can install your fire quickly and easily, irrespective of the built-in set-up. There are 3 options for the extraction of flue gases.

1. Connection without any extraction materials to an existing chimney flue (sealed with ceramic wool)
2. Connection with flexible or rigid pipe (Linerkit Pro), Ø 150 or 180 mm
3. Connection with flue pipe with reduced end (connector), Ø 150 or 180 mm

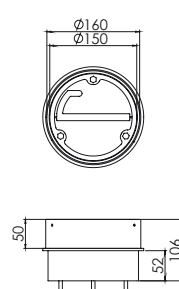

Ø 150 mm

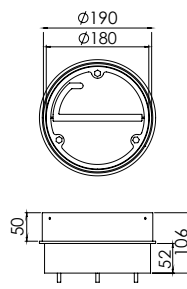

Ø 180 mm

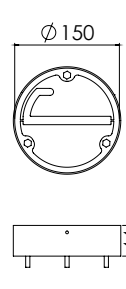

Ø 150 mm

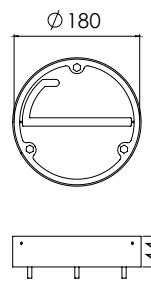

Ø 180 mm

Frames for Instyle / Prostyle 500^{EA}-1000^{EA} range, Tunnel^{EA/RS}

The Dik Geurts insert and built-in fires are ideal for existing chimney installation. All models are available with a wide range of frames. The Tunnel version can also be installed with 2 different frames. Installing without a frame is also possible of course, as are custom-made frame solutions (see pg. 26).

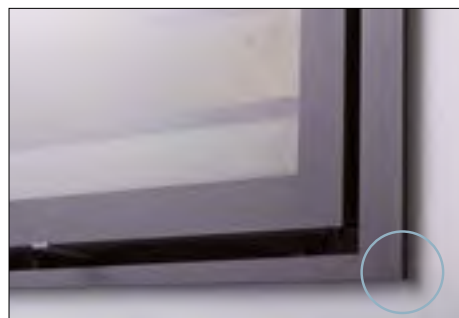

Frame Classic Line 3S, 40 mm (solid, base section of frame 20 mm)

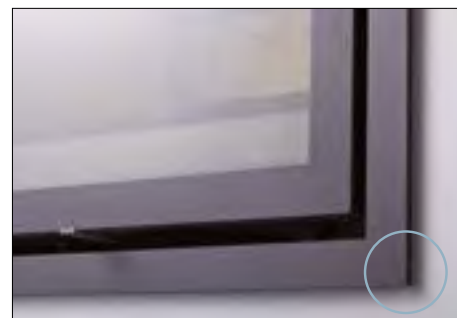

Frame Classic Line 4S, 40 mm (solid)

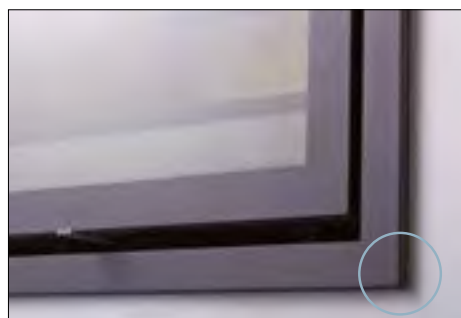

Frame Modern Line 40 mm (sloped sides)

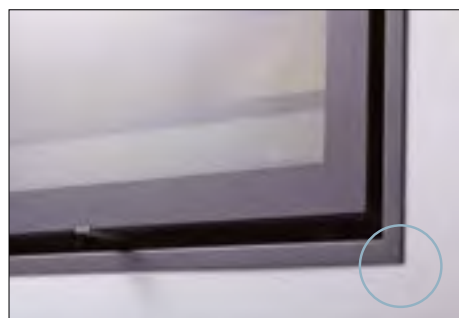

Frame Slim Line 20 mm (sloped sides)

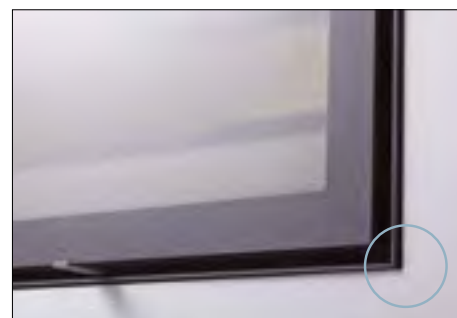

Without frame (built-in frame)

Frames for Instyle / Prostyle 600V^{EA}-1000V^{EA} range (with ventilating fan)

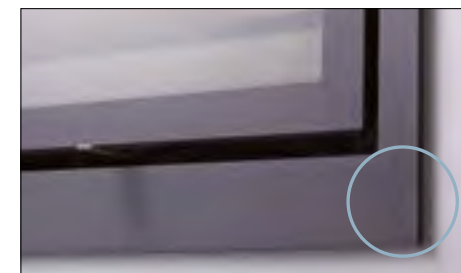

Frame Classic Line, 40 mm (solid, base section of frame 96 mm)

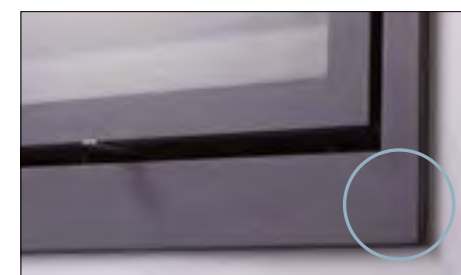

Frame Modern Line, 40 mm (sloped sides)

Frame dimensions								
Type of frame		Instyle/Prostyle						
		500 ^{EA}	550 ^{EA}	600 ^{EA}	650 ^{EA}	700 ^{EA} -Tunnel	800 ^{EA}	1000 ^{EA}
Classic Line 4S	WxH	580 x 537	587 x 617	660 x 537	710 x 552	760 x 657	860 x 637	1060 x 637
Classic Line 3S	WxH	580 x 517	-	660 x 517	710 x 532	-	-	-
Modern Line	WxH	580 x 537	587 x 617	660 x 537	710 x 600	760 x 657	860 x 637	1060 x 637
Slim Line	WxH	540 x 497	547 x 577	620 x 497	670 x 512	720 x 617	820 x 597	1020 x 597
Built-in	WxH	600 x 557	607 x 637	680 x 557	730 x 572	780 x 677	880 x 657	1080 x 657

Frame dimensions			
Type of frame		Instyle/Prostyle V	
		600V ^{EA}	700V ^{EA}
Classic Line	WxH	660 x 649	760 x 769
Modern Line	WxH	660 x 649	760 x 769

Frame dimensions			
Type of frame		Instyle/Prostyle V	
		800V ^{EA}	1000V ^{EA}
Classic Line	WxH	860 x 749	1060 x 749
Modern Line	WxH	860 x 749	1060 x 749

EA: External air connection

External air kit

Kit that provides a fresh outdoor air supply
Very suitable for well insulated homes

- Optional with 500^{EA} - 1000^{EA}, 600V^{EA} - 1000V^{EA}, Tunnel^{EA} (only base)
- For rear and base connection
- Dimensions Ø 80 mm

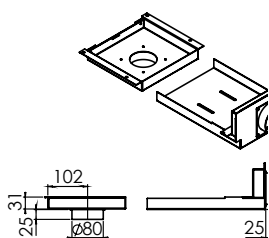

Linerkit Pro

Connection set for flexible or rigid flue gas vent

- Optional with 500^{EA} - 1000^{EA}, 600V^{EA} - 1000V^{EA}, Corner^{EA}, Triple^{EA}, Tunnel^{EA/RS}
- Connection runs via the interior of the fire
- Reducer with 3 screw holes
- Dimensions Ø 150 mm, Ø 180 mm

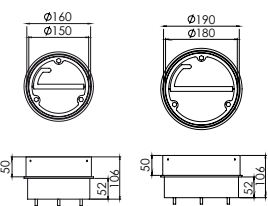

Linerkit

Connection set for flexible flue gas vent

- Optional with Vision^{EA}
- Stainless steel vent with 3 flexible strips
- Clamp with closing clip and lock
- Dimension Ø 150 mm

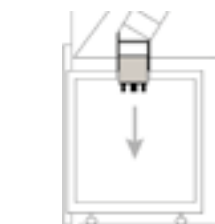

Connector

Connection set for flue pipe with reduced end

- Optional with 500^{EA} - 1000^{EA}, 600V^{EA} - 1000V^{EA}, Corner^{EA}, Triple^{EA}, Tunnel^{EA/RS}
- Reducer with 3 screw holes
- Dimensions Ø 150 mm, Ø 180 mm

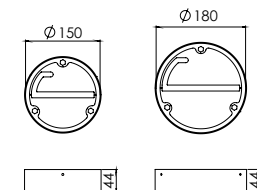

Convection kit

Connective rings [2] for assembly on convection holes

- Optional with 500^{EA} - 1000^{EA}, 600V^{EA} - 1000V^{EA}, Tunnel^{EA/RS}
- For increased heat output
- Dimensions Ø 125 mm

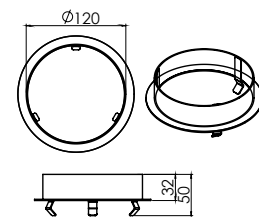

Moisture meter

Measuring whether wood is dry enough

- For optimum combustion
- For all Dik Geurts fires



Floor plates

For complete assembly and extra floor protection
Steel, dark anthracite

- Rectangular (wxd): 600x800 mm / 800x1000 mm
- Rectangular (wxd) with rounded front: 800x700 mm
- Square (wxd): 1000x1000 mm
- Round (Ø): 1000 mm, 1200 mm
- Round (Ø) with straight back side: 850 mm
- Custom made



EA: External air connection

Aste 5 Low ^{EA/RS}	
Output	4.9-7 kW
Efficiency	82.0%

What is striking about the Aste^{EA/RS} is its classic look, realised by the beautifully designed legs and robust cast iron door. The centre of the flue pipe is located only 10 cm from the rear side. The result is that this wood burner can be easily placed inside an existing fire-place. A heat shield is also available for this stove, allowing you to place it closer to a flammable wall.

- Upper and rear chimney connection
- Version EA/external air, or RS/room sealed (see pg. 40)
- Accessories: external air kit (EA version), multi-fuel kit (for burning multi-fuel/coal), flue pipe with adapter Ø 125-130 mm (12 and 100 cm), heat shield stove

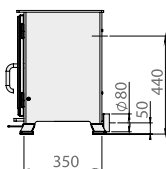
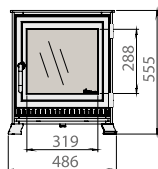
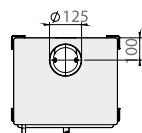

Aste 5 Low^{EA/RS}





Ivar 5 Low ^{EA/RS} / High ^{EA/RS}	
Output	4.9-7 kW
Efficiency	82.0%

The Ivar 5 comes in 2 versions. It is also available in wood or multi-fuel models, that can burn coke or coal. These wood-burners are ideal for both new-build and installation in existing locations, e.g. under a chimney. The Ivar 5 has a cast iron door that can be easily opened using the removable handle.

- Upper and rear chimney connection
- Version EA/external air, or RS/room sealed (see pg. 40)
- Accessories: external air kit (EA version), multi-fuel kit (for burning multi-fuel/coal), flue pipe with adapter Ø 125-130 mm (12 and 100 cm), heat shield stove

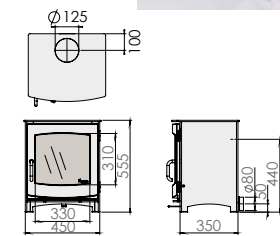

Ivar 5 Low^{EA/RS}

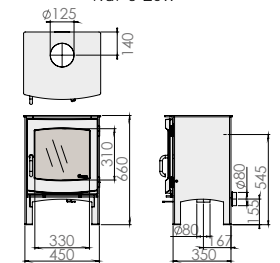

Ivar 5 High^{EA/RS}



Ivar 5 High^{EA/RS}

Ivar 5 Low^{EA/RS}

Ivar 5 Store ^{EA/RS}	
Output	4.9-7 kW
Efficiency	82.0%

This free-standing wood burner is equipped with a cast-iron door with a detachable handle. The extra space under the burner can be used to store logs. The flue can be connected either on the top or the back.

- Upper and rear chimney connection
- Version EA/external air, or RS/room sealed (see pg. 40)
- Accessories: external air kit (EA version), multi-fuel kit (for burning multi-fuel/coals), flue pipe with adapter Ø 125-130 mm (12 and 100 cm), heat shield stove

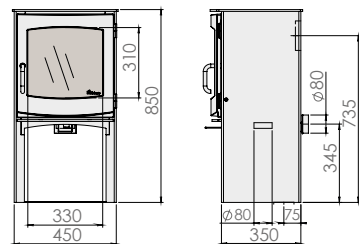
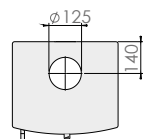

Ivar 5 Store^{EA/RS}





Ivar 8 Low ^{EA/RS}	
Output	6-10 kW
Efficiency	76.6%

This wood burner is an ideal height for placement under an existing mantle. With an optional heat shield, the wood burner can be placed closer (to 20 cm) to the wall (of combustible material). The 'cold' handle is detachable.

- Upper and rear chimney connection
- Accessories: external air kit (EA version), multi-fuel kit (for burning multi-fuel/coins), heat shield stove and flue

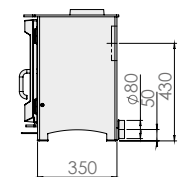
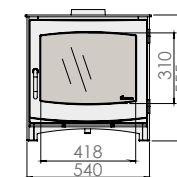
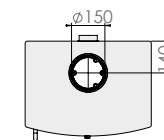

Ivar 8 Low^{EA/RS}

Ivar 8 Store ^{EA/RS}	
Output	6-10 kW
Efficiency	76.6%

A large glass pane and a fantastic capacity are key attributes of the Ivar 8 Store^{EA/RS}. The sliding air vent ensures optimum fire regulation. An optional heat shield saves on space as the wood burner can be placed even closer to the wall (of combustible material).

- Upper and rear chimney connection
- Accessories: external air kit (EA version), multi-fuel kit (for burning multi-fuel/coal), heat shield stove and flue

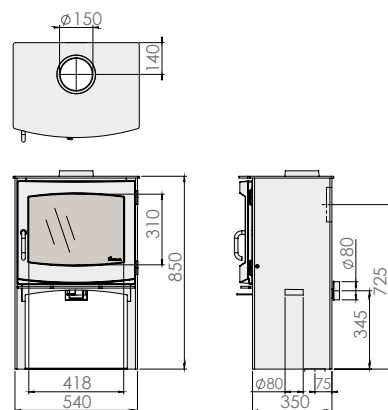

Ivar 8 Store^{EA/RS}





Keld 5 High^{EA/RS}

Keld 5 Low^{EA/RS}

Keld 5 Low ^{EA/RS} / High ^{EA/RS}	
Output	4.9-7 kW
Efficiency	82.0%

The Keld stove comes in High and Low versions. It is also available in wood or multi-fuel versions, which can burn coke or coal. It is equipped with a cast iron door with curved corners. The Low version is perfect for installation under an existing chimney. The air-slider allows the fire to be regulated effectively. The rated output is 4.9 kW.

- Upper and rear chimney connection
- Version EA/external air, or RS/room sealed (see pg. 40)
- Accessories: external air kit (EA version), multi-fuel kit (for burning multi-fuel/coals), flue pipe with adapter Ø 125-130 mm (12 and 100 cm), heat shield stove

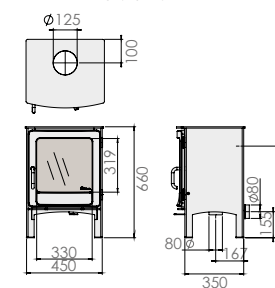
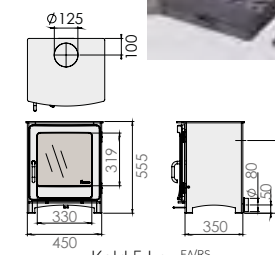

Wood, freestanding cast iron stoves, DRU



designed to be different



CONTENTS

- 51 Why choose DRU?
- 52 Wood stove technology and the environment
- 53 DRU44MF
- 54 DRU55CB, DRU55MF
- 55 DRU64CB, DRU64MF
- 56 DRU78CB, DRU78MF
- 57 Colours and accessories

WHY A DRU STOVE?

Why buy a stove?

At the end of the day or if you are enjoying spending time with family and friends you look for a place where you can relax. A place where you can chat or read. This place has been by the stove for many centuries!

Why choose a cast iron stove?

- Composed from almost completely recycled material
- Durable and robust material
- Long-lasting heat from an ideal heat conductor
- Strong and sustainable heat source

What to pay attention to?

Pay attention to the following points when purchasing a wood stove:

- Capacity and efficiency of the stove
- Is the stove CE approved, according to DIN+
- Complete combustion, therefore environmentally friendly
- Convenient operation and appearance

Why choose DRU?

- Reliable producer with more than 260 years experience
- Everything under one roof, from design and development to finished product
- All DRU stoves are approved in accordance with the most stringent requirements
- Stoves are produced from strong and durable material for optimum performance

Energy label

- All DRU wood stoves are supplied with an energy label
- The label contains an energy efficiency class
- This energy class helps you to choose the perfect wood stove

Approvals

DRU multi-fuel and wood-burning stoves burn wood, coal, coke, brown coal or anthracite. They are made from the toughest Norwegian cast iron and are designed for the harshest climates. All models meet the most stringent quality requirements (EN13240 and according to DIN) and belong in the combustion technique elite.

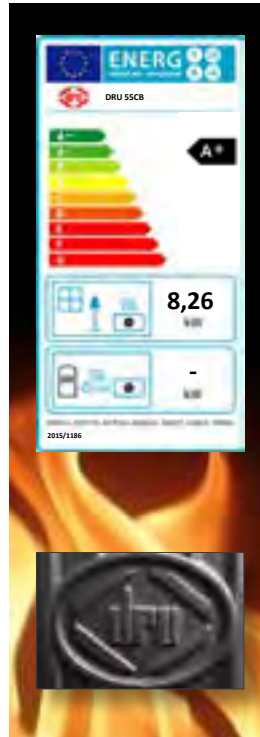

BENEFITS CLEAN BURNING (CB) AND MULTI-FUEL (MF)

Clean Burning (CB)

DRU cast iron wood stoves are equipped with a unique triple burning system.

- (1) The primary air that is pulled in from beneath the fire plate is only used to start the burning process.
- (2) The secondary air comes in through the back of the stove and is fed through special air inlets in the back and lower chambers at the front of the unit. A portion of this pre-heated air also takes care of the 'air wash' of the glass window as well as another part of the after burning process of the exhaust fumes.
- (3) A third opening at the rear of the stove injects the tertiary air, through small holes in the back of the combustion chamber.

- Almost total combustion of wood, resulting in less wood consumption

Multi-Fuel (MF)

DRU multi-fuel stoves are designed to burn wood as well as coal

- Combustion controlled by an adjustable thermostat*
- Also suitable as multi-fuel stove (wood, coke and coal) with an optional coal funnel*

* Only for DRU64MF and DRU78MF



WOOD/COAL FUEL AND THE ENVIRONMENT

Responsible wood burning

When a tree is burned almost the same quantity of CO₂ is released as the tree absorbed through photosynthesis.

This means that wood in a wood stove releases almost no extra CO₂ into the atmosphere, thereby creating a closed cycle. Another advantage of wood is that it is a sustainable, ecologically renewable resource that will not run out.

Wood is the fuel of the future. Naturally, DRU also supplies multi-fuel stoves in which you can use both wood and coal.

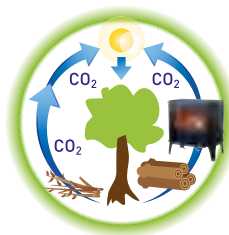

Some tips for climate-neutral heating:

- Choose a DRU wood stove that meets the most stringent environmental standards
- Regularly inspect the flue
- Only burn clean and dry firewood (max. 20% moisture content)
- Ensure that there is sufficient ventilation for effective combustion

Conditions for environmentally friendly heating

For complete combustion it is necessary to harmonise the capacity of a stove to the size of the living space. The correct capacity guarantees complete combustion and is therefore environmentally friendly. The output of a wood stove is also of great importance. Using sustainable materials and sophisticated techniques enable DRU wood stoves to guarantee complete combustion, clean emissions and a high efficiency, up to 80%.

DRU TECHNOLOGY

DRU cast iron stoves

- Cast iron: durable and indestructable
- Approved CE according to DIN+
- Primary, secondary and tertiary* combustion
- Airwash system for clean windows

* except DRU44MF



Thermostatic control
(64MF | 78MF)

DRU55CB | DRU64CB | DRU78CB

CB VERSION



Wood burning stoves

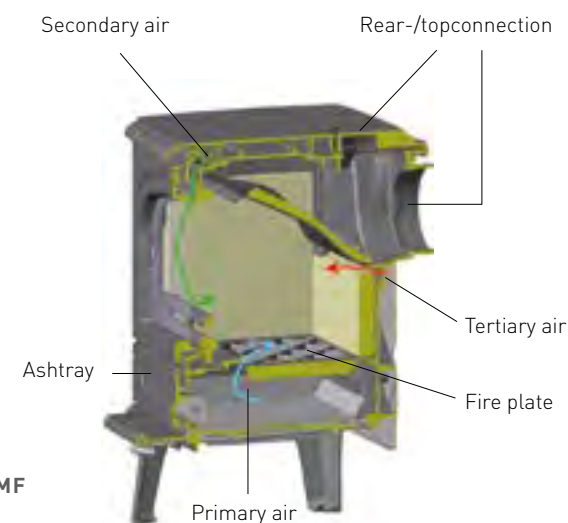

DRU44MF | DRU55MF | DRU64MF | DRU78MF

MF VERSION



Multi-fuel stoves



DRU44MF anthracite

DRU44MF	
Output	4-7 kW
Efficiency	78%



DRU44MF, with coals

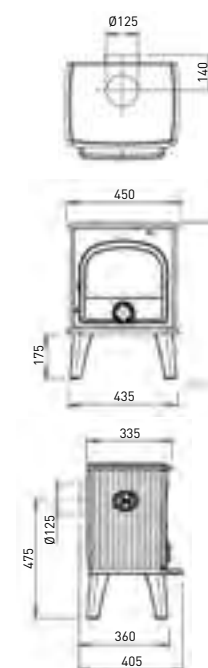

DRU44MF

Option: Minimal height (with extra short legs)

DRU55CB/MF	
Output	6-10 kW
Efficiency	80%



DRU55MF, with coals

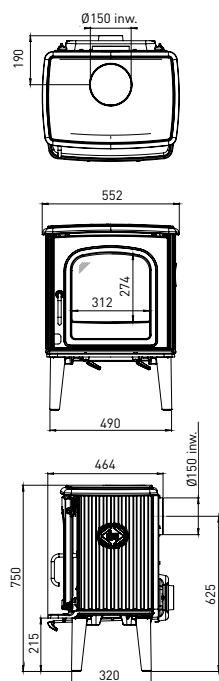

DRU55CB/MF



DRU55CB anthracite



DRU64CB anthracite

DRU64CB/MF	
Output	8-12 kW
Efficiency	75%



DRU64CB enamel cream white



DRU64CB/MF

DRU64CB cast iron **A** / DRU64MF cast iron **A**



designed to be different

DRU78CB/MF	
Output	9-13 kW
Efficiency	75%



DRU78MF, with coals



DRU78CB/MF



DRU78CB anthracite

Colour options

The standard paint colour for DRU cast iron stoves is 'anthracite'. We can also supply these stoves in optional enamelled colours. Enamelled surfaces are of a superior quality and also very easy to clean.

Accessories

DRU supplies a great many accessories for the multi-fuel/coal stoves. A set of short legs lowers the height of the stove. This may be necessary in order to place the stove in normal situations. A coal bunker will enable you to use the stove for a long time without requiring any extra attention. The pieces of coal are supplied via the funnel and slide down automatically into the combustion chamber.

Shorter leg option (DRU44MF)

- Reduces height of stove from 625 mm to 555 mm
- Set of 4 legs
- Colour: anthracite or enamel

External air kit (DRU64CB/MF / DRU78CB/MF)

- Fresh outdoor air kit, Ø 100 mm
- For well-insulated homes
- Standard on DRU55CB/MF

Flue material in enamel (DRU44/55/64/78 CB/MF)

Available in Ø 125 mm and Ø 150 mm

- Pipe 110, 250, 500, 750, 1000 mm
- Bend 45°, 90°
- T-piece
- Rosette

Flue gas thermometer (DRU44/55/64/78 CB/MF)

- For optimum wood burning
- Less wood consumption
- Increased efficiency

Moisture meter

- Measuring whether wood is dry enough
- Optimum combustion



1 cast iron anthracite



E6 enamel majolica brown



E8 enamel cream white



Short legs



Flue gas thermometer, magnetic

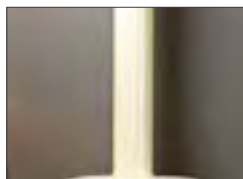

Flue material in enamel



Moisture meter



External air kit

Page	Gas fireplaces	Net capacity (kW)			Efficiency (%) G20	Energy efficiency class			Duct Ø (mm)	Built-in depth (mm)	Weight (kg)	Interior finish				Fire bed		
		natural gas G20	natural gas G25.3 (NL)	propane G31		G20	G25.3 (NL)	G31				black	Ceraglass	natural	classic stone	logs	stones	glass
	Open combustion																	
17	Global 40 CF	1.6-3.3	1.3-3.1	1.5-3.1	81.1	C	C	C	80	291	80	-	+	-	-	+	-	-
18	Global 55 CF	1.9-3.9	1.5-3.7	1.9-4.0	77.7	C	C	C	100	320	43	+	+	-	+	+	-	-
19	Global 55XT CF	1.7-4.5	1.7-4.2	1.8-4.4	74.3	D	D	D	100	320	43	+	+	-	+	+	-	-
20	Global 70XT CF	2.0-4.7	2.0-4.6	2.9-4.8	77.4	C	D	C	100	350	63	+	+	+	+	+	-	-
21	Global Beau CF (freestanding)	1.6-3.3	1.3-3.1	1.5-3.1	81.1	C	C	C	80	330	60	-	+	-	-	+	-	-
	Closed combustion																	
9	Global 55XT Cavity BF	1.8-3.2	-	-	77.1	C	-	-	150/100	255	43	-	+	-	-	+	-	-
10	Global 60XT BF	2.5-6.5	2.3-6.0	3.3-6.8	91.9	A	A	A	150/100	295	61	+	+	-	-	+	+	-
11	Global 70XT BF	3.1-7.0	2.7-6.2	3.3-6.3	88.5	A	B	A	150/100	362	70	+	+	+	+	+	-	-
12	Global 100 BF	2.8-7.5	2.6-7.1	3.5-7.0	94.0	A	A	A	150/100	360	75	+	+	-	-	+	+	+
12	Global 120 BF	2.8-7.5	2.6-7.1	3.5-7.0	94.0	A	A	A	150/100	360	120	+	+	-	-	+	+	+
13	Global 60 Corner BF	2.3-6.0	2.1-5.4	3.0-6.2	91.5	A	A	A	150/100	325	62	+	+	-	-	+	+	-
14	Global 100 Corner BF	2.8-7.5	2.6-7.1	3.5-7.0	94.0	A	A	A	150/100	386	100	+	+	-	-	+	+	+
14	Global 120 Corner BF	2.8-7.5	2.6-7.1	3.5-7.0	94.0	A	A	A	150/100	386	120	+	+	-	-	+	+	+
15	Global 60 Triple BF	2.3-6.0	2.1-5.4	3.0-6.2	91.5	A	A	A	150/100	340	65	+	+	-	-	+	+	-
16	Global 100 Triple BF	2.8-7.5	2.6-7.1	3.5-7.0	94.0	A	A	A	150/100	386	100	+	+	-	-	+	+	+
16	Global 120 Triple BF	2.8-7.5	2.6-7.1	3.5-7.0	94.0	A	A	A	150/100	386	120	+	+	-	-	+	+	+

Page	Wood fireplaces	Output kW	Efficiency (%)	Energy efficiency class	Flue (mm)			External air connection	Max. log length (cm)	Type		Weight (kg)
					Ø mm	upper	rear			insert	built-in	
	Dik Geurts											
	Instyle insert and built-in fires											
28	Instyle 500 ^{EA}	3-7	82.0	A+	150	+	-	○	25	+	+	80
28	Instyle 550 ^{EA}	3-7	81.0	A+	150	+	-	○	25	+	+	94
28	Instyle 600 ^{EA}	3-7	80.0	A+	150	+	-	○	33	+	+	120
28	Instyle 650 ^{EA}	3-9	80.5	A+	150	+	-	○	25	+	+	108
29	Instyle 700 ^{EA}	8-12	81.9	A+	180	+	-	○	33	+	+	116
29	Instyle 800 ^{EA}	8-12	76.6	A	180	+	-	○	50	+	+	130
29	Instyle 1000 ^{EA}	9-13	77.7	A	180	+	-	○	50	+	+	145
30	Instyle Corner Low ^{EA}	4-9	83.0	A+	150	+	-	●	33	+	-	105
30	Instyle Corner High ^{EA}	4-9	83.0	A+	150	+	-	●	33	+	-	105
31	Instyle Triple Low ^{EA}	4-9	83.0	A+	150	+	-	●	25	+	-	102
32	Instyle Tunne ^{EA/RS}	9-12	83.0	A+	180	+	-	EA: ○ RS: ●	33	+	+	140
	With ventilating fan											
39	Instyle 600V ^{EA}	4-7	80.0	A	150	+	-	○	33	+	-	130
39	Instyle 700V ^{EA}	8-12	81.9	A+	180	+	-	○	33	+	-	126
39	Instyle 800V ^{EA}	8-12	76.6	A	180	+	-	○	33	+	-	140
39	Instyle 1000V ^{EA}	9-13	77.7	A	180	+	-	○	33	+	-	155

EA: External air connection, RS: External air connection, room sealed (100% airtight)

● including, ○ accessory, - not applicable

Page	Wood fireplaces	Output kW	Efficiency (%)	Energy efficiency class	Flue (mm)			External air connection	Max. log length (cm)	Type		Weight (kg)
	Dik Geurts				Ø mm	upper	rear			insert	built-in	
Prostyle/Vision insert and built-in fires (with screen-printed glass)												
34	Prostyle 500 ^{EA}	3-7	82.0	A+	150	+	-	○	25	+	+	80
34	Prostyle 550 ^{EA}	3-7	81.0	A+	150	+	-	○	25	+	+	94
34	Prostyle 600 ^{EA}	3-7	80.0	A+	150	+	-	○	33	+	+	120
34	Prostyle 650 ^{EA}	3-9	80.5	A+	150	+	-	○	25	+	+	108
35	Prostyle 700 ^{EA}	8-12	81.9	A+	180	+	-	○	33	+	+	124
35	Prostyle 800 ^{EA}	8-12	76.6	A	180	+	-	○	50	+	+	130
35	Prostyle 1000 ^{EA}	9-13	77.7	A	180	+	-	○	50	+	+	130
36	Prostyle Tunnel ^{EA}	9-12	83.0	A+	180	+	-	○	50	+	+	140
37	Vision 80 ^{EA}	6-9	84.6	A+	150	+	-	●	50	-	+	145
37	Vision 100 ^{EA}	7-10	84.6	A+	150	+	-	●	50	-	+	132
	With ventilating fan											
39	Prostyle 600V ^{EA}	4-7	80.0	A	150	+	-	○	33	+	-	130
39	Prostyle 700V ^{EA}	8-12	81.9	A+	180	+	-	○	33	+	-	126
39	Prostyle 800V ^{EA}	8-12	76.6	A	180	+	-	○	33	+	-	140
39	Prostyle 1000V ^{EA}	9-13	77.7	A	180	+	-	○	33	+	-	155

EA: External air connection

● including ○ accessory - not applicable

Page	Wood stoves	Output kW	Efficiency (%)	Energy efficiency class	Flue (mm)			External air connection	Max. log length (cm)	Colours		Weight (kg)
	Dik Geurts				Ø mm	upper	rear			dark anthracite	enamel colours	
44	Aste 5 Low ^{EA/RS}	4.9-7	82.0	A+	125/130	+	+	EA: ○ RS: ●	33	+	-	85
45	Ivar 5 Low ^{EA/RS}	4.9-7	82.0	A+	125/130	+	+	EA: ○ RS: ●	33	+	-	85
45	Ivar 5 High ^{EA/RS}	4.9-7	82.0	A+	125/130	+	+	EA: ○ RS: ●	33	+	-	90
46	Ivar 5 Store ^{EA/RS}	4.9-7	82.0	A+	125/130	+	+	EA: ○ RS: ●	33	+	-	105
47	Ivar 8 Low ^{EA/RS}	6-10	76.6	A	150	+	+	EA: ○ RS: ●	33	+	-	100
48	Ivar 8 High ^{EA/RS}	6-10	76.6	A	150	+	+	EA: ○ RS: ●	33	+	-	120
49	Keld 5 Low ^{EA/RS}	4.9-7	82.0	A+	125/130	+	+	EA: ○ RS: ●	33	+	-	85
49	Keld 5 High ^{EA/RS}	4.9-7	82.0	A+	125/130	+	+	EA: ○ RS: ●	33	+	-	90

EA: External air connection

● including ○ accessory - not applicable



designed to be different

Page	Wood stoves	Output kW	Efficiency (%)	Energy efficiency class	Flue (mm)			Fuel		External air connection	Max. log length (cm)	Colours		Weight (kg)
	DRU				Ø mm	upper	rear	Wood	Multi-fuel			dark anthracite	enamel colours	
53	DRU44MF	4-7	> 78	A	125 ¹⁾	+	+	+	+	○	25	+	+	95
54	DRU55CB	6-10	> 80	A+	150	+	+	+	-	○	25	+	+	135
54	DRU55MF	6-10	> 79	A	150	+	+	+	+	○	33	+	+	149
55	DRU64CB	8-12	> 75	A	150	+	+	+	-	○	50	+	+	195
55	DRU64MF	8-12	> 79	A	150	+	+	+	+	○	33	+	+	205
56	DRU78CB	9-13	> 80	A+	150	+	+	+	-	○	50	+	+	245
56	DRU78MF	9-13	> 80	A+	150	+	+	+	+	○	50	+	+	250

¹⁾ Standard: 125 mm external. Option: 125 mm internal.

● including, ○ accessory, - not applicable



Energy efficiency class

Technical specifications

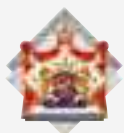

BY APPOINTMENT OF
THE COURT OF THE NETHERLANDS

since
1754

Drugasar Ltd.
Deans Road | Swinton
Manchester | M27 0JH
United Kingdom
T. +44 (0)161 - 793 8700
F. +44 (0)161 - 727 8057
www.drufire.co.uk
www.dikgeurts.uk

DRU Verwarming B.V.
Postbus 1021 | 6920 BA Duiven
Ratio 8 | 6921 RW Duiven
The Netherlands
T. +31 (0)26 - 319 5 319
F. +31 (0)26 - 319 5 348
www.dru.nl

DRU Belgium
Kontichsesteenweg 69/1
2630 Aartselaar
Belgium
T. +32 (0)3 - 450 7000
F. +32 (0)3 - 450 7009
www.drufire.be

Dealer



www.drufire.com

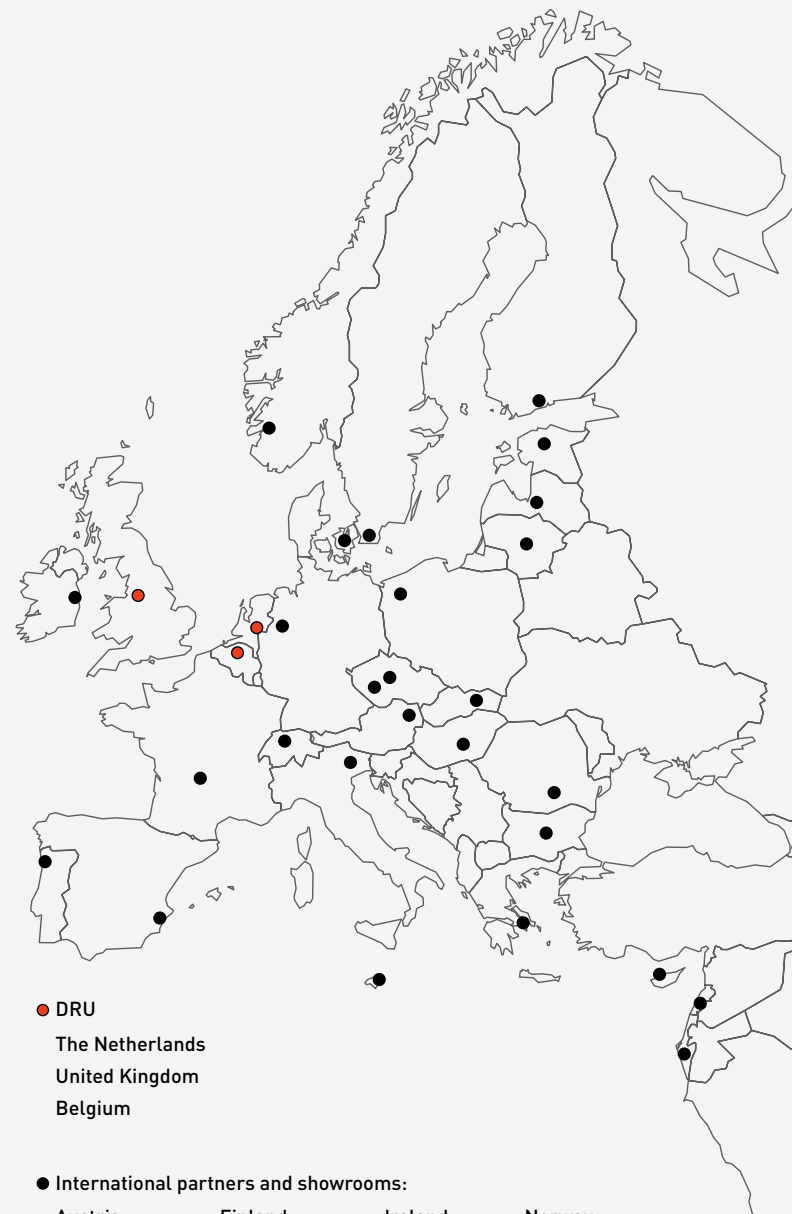

● International partners and showrooms:

Austria	Finland	Ireland	Norway
Bulgaria	France	Israel	Poland
Croatia	Georgia	Italy	Portugal
Cyprus	Germany	Latvia	Romania
Czech Republic	Greece	Lebanon	Spain
Denmark	Hungary	Lithuania	Sweden
Estonia	Iran	Malta	

